

DENALI

EXTREME LED LIGHTING BY TWISTED THROTTLE

Kit Contents

Denali Fender Mount Kit DM

SKU: LAH.00.10100

Instruction Rev: 00

Twisted Throttle LLC
570 Nooseneck Hill Rd
Exeter, RI 02822

Phone: 401.284.4200
Fax: 401.223.6954
www.twistedthrottle.com

PLEASE READ BEFORE INSTALLING

TWISTED THROTTLE products should be installed by a qualified, experienced motorcycle technician. If you are unsure of your ability to properly install a product, please have the product installed by your local motorcycle dealer. TWISTED THROTTLE takes no responsibility for damages caused by improper installation.

Medium strength liquid thread-locker (i.e., "Locktite") should be used to secure all screws, bolts, and nuts.

All screws, bolts, and nuts should be checked after driving the first 30 miles (50 km) to ensure that all are tightened to the proper torque.

All screws, bolts, and nuts, including all replacement hardware provided by TWISTED THROTTLE should be tightened to the torque specified in the OEM maintenance manual for your motorcycle. If no torque specifications are provided in the OEM maintenance manual, the following torques may be used:

| | |
|----------|-------------------|
| M5..... | 3.5 ft-lbs (5 Nm) |
| M6..... | 6.5 ft-lbs (9 Nm) |
| M8..... | 16 ft-lbs (22 Nm) |
| M10..... | 32 ft-lbs (43 Nm) |
| M12..... | 55 ft-lbs (75 Nm) |



Step 1

| | | |
|---|---|---|
| 1 Spacer  #AS50-14-96 Qty.....2 | 2 Socket Head Screw  M5x60.....ISO 7380 Qty.....2 | 3 Socket Head Screw  M6x60.....ISO 7380 Qty.....2 |
|---|---|---|

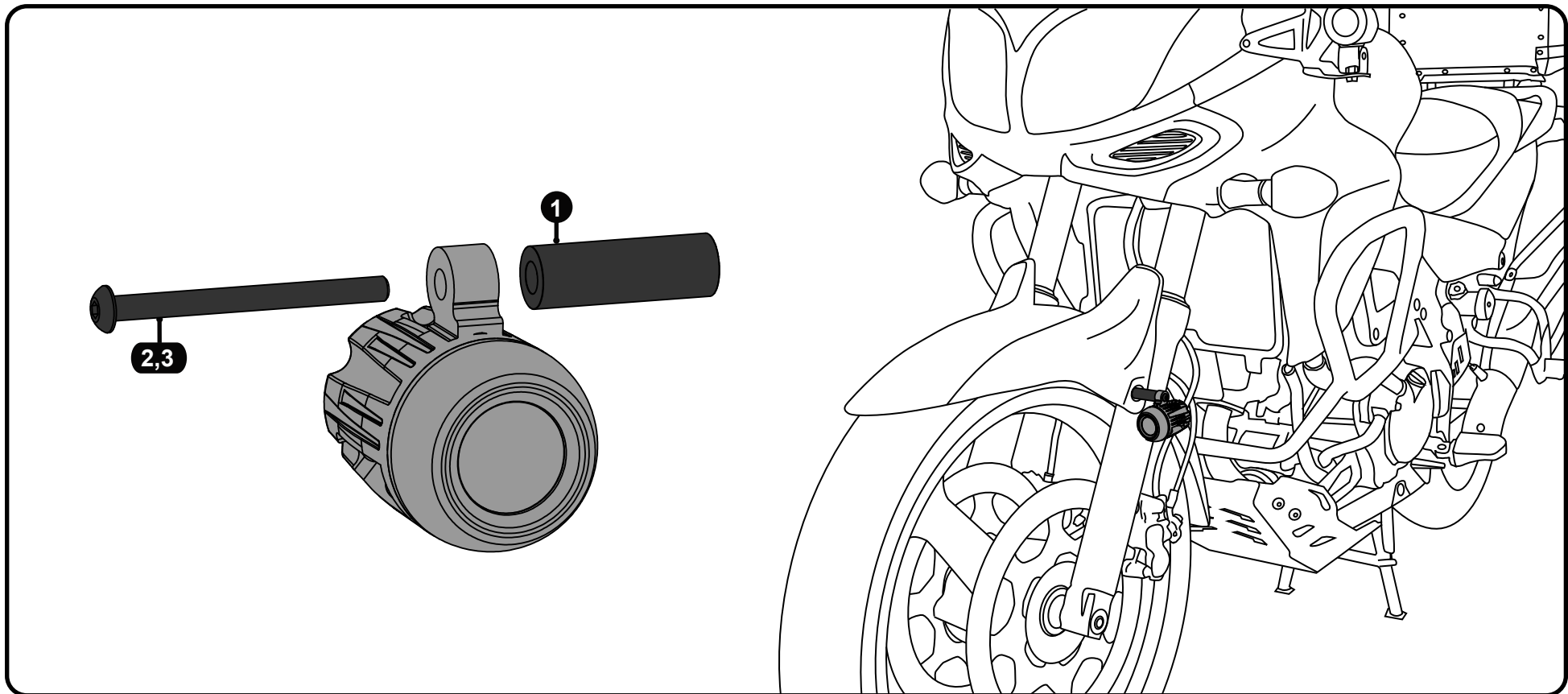

Step One: Determine if your motorcycles fender mounts are using M5 or M6 bolts, then assemble the light pod and hardware accordingly. Once assembled bolt the light pod directly to your fenders mounting points.